

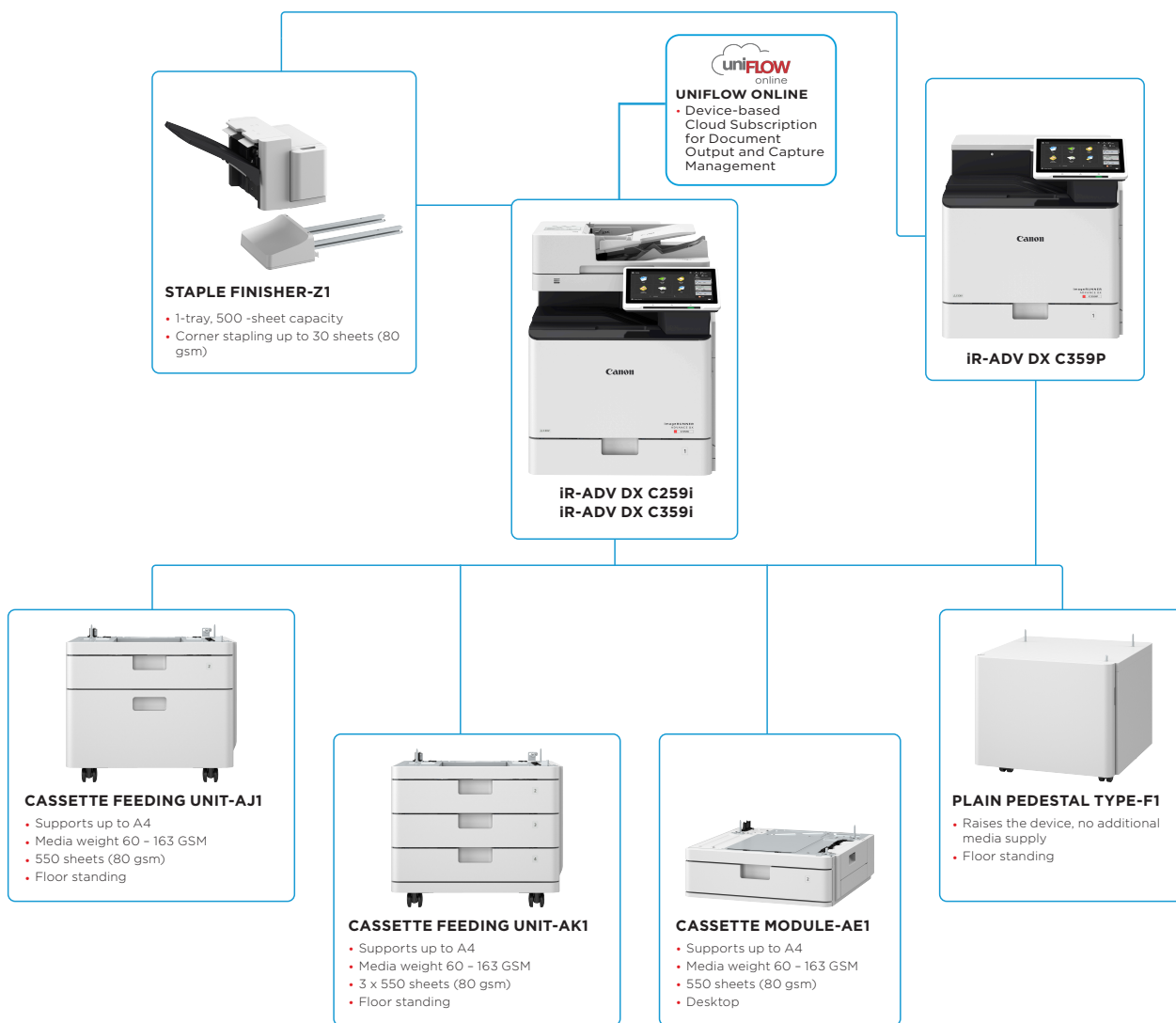

Canon Europe Ltd.  
B11202024 How: 04-919-41 Brand

# COMPACT COLOUR A4 DEVICES WITH STREAMLINED WORKFLOWS FOR FAST, HIGH-QUALITY PRINTING AND SCANNING.

## MAIN CONFIGURATION OPTIONS



This flat configuration is for illustration purpose only. For a complete list of options and the exact compatibility relationships, please refer to the [online product configurator](#).

The Unified Firmware Platform (UFP) ensures that the latest feature upgrades and protection are available, for an enhanced user experience across the entire iR ADVANCE DX portfolio.

# TECHNICAL SPECIFICATIONS

# imageRUNNER ADVANCE DX C259/C359 Series

<b>MAIN UNIT</b>	A4 Colour Laser Multifunctional	<b>Operating System</b>	UFR II: Windows® 8.1/10/11/Server2012/Server2012 R2/Server2016/Server2019/Server2022, Mac OS X (10.11 or later)
<b>Machine type</b>	Print, Copy*, Scan*, Send*, Store and Optional Fax* * Not applicable to iR-ADV DX C359P (Printer model)	<b>COPY SPECIFICATIONS</b>	PCL: Windows® 8.1/10/11/Server2012/Server2012 R2/Server2016/Server2019/Server2022 PS: Windows® 8.1/10/11/Server2012/Server2012 R2/Server2016/Server2019/Server2022, Mac OS X (10.11 or later) PPD: Windows® 8.1/10/11, Mac OS X (10.11 or later)
<b>Core functions</b>	1.8GHz Dual Core Processor	<b>Copy Speed* (BW/CL)</b>	iR-ADV DX C359i 35 ppm (A4), 26 ppm (A5R), 61 ppm (A5), 23 ppm (A6) iR-ADV DX C259i 25 ppm (A4), 26 ppm (A5R), 46 ppm (A5), 23 ppm (A6) * Single-sided
<b>Processor</b>	10.1" TFT LCD WSVGA Color Touch panel	<b>First-Copy-Out Time (A4; BW/ CL)</b>	iR-ADV DX C359i: Approx. 5.1/6.9 seconds or less iR-ADV DX C259i: Approx. 6.9/9.4 seconds or less
<b>Control Panel</b>	Standard: 3.5GB RAM	<b>Copy resolution (dpi)</b>	600 x 600, 300 x 600
<b>Memory</b>	Standard: (SSD) 256 GB	<b>Multiple Copies</b>	Up to 999 copies
<b>Hard Disk drive</b>	NETWORK Standard: 1000Base-T/100Base-TX/10Base-T Optional: Wireless LAN (IEEE 802.11 b/g/n)	<b>Copy Density</b>	Automatic or Manual (9 Levels)
<b>Interface Connection</b>	OTHERS Standard: USB 2.0 (Host) x1, USB 3.0 (Host) x1, USB 2.0 (Device) x1; Optional: Serial Interface, Copy Control Interface	<b>Magnification</b>	Variable zoom: 25% to 400% (1% Increments) Preset reduction/enlargement: 25%, 50%, 70%, 100%(1:1), 141%, 200%, 400%
<b>Paper Supply Capacity (A4, 80gsm)</b>	Standard: 650 Sheets 100-sheets Multi-purpose tray 550-sheets Paper cassette x1 Maximum: 2,300 Sheets (with Cassette Feeding Unit-AK1)	<b>Copy Features</b>	Preset R/E Ratios by Area, Two-Sided, Density Adjustment, Original Type Selection, Interrupt Mode, Two-sided Original, Job Build, N on 1, Page Numbering, Copy Set Numbering, Sharpness, Erase Frame, Secure Watermark, Print Date, Copy ID Card, Skip Blank Pages, Color Mode, Reserved copy, Copy Sample
<b>Paper output capacity (A4, 80gsm)</b>	Standard: 250 Sheets Maximum: 500 Sheets (with Staple Finisher-Z1)	<b>SCAN SPECIFICATIONS</b>	
<b>Finishing capabilities</b>	Standard: Collate, Group With Finisher : Collate, Group, Offset, Staple	<b>Standard type</b>	Single-pass Duplexing Automatic Document Feeder* [2-sided to 2-sided (Automatic)] * Detect Feeder Multi Sheet Feed is supported.
<b>Supported media types</b>	Multi-purpose tray: Thin, Plain, Heavy, Recycled, Color, Transparency, Pre-punched, Bond, Label, Envelope Paper Cassette: Thin, Plain, Heavy, Recycled, Color, Pre-punched, Bond, Envelope*	<b>Document Feeder Paper Capacity (80 gsm)</b>	100 Sheets
<b>Supported media sizes</b>	Multi-purpose tray: Standard size: A4, A5, A5R, A6, B5, Custom Size: 98.0 x 148.0 mm to 216.0 x 355.6 mm Envelopes: COM10 No.10, Monarch, DL, ISO-C5 Envelope custom size: 98.0 x 148.0 mm to 216.0 x 355.6 mm Paper Cassette: Standard size: A4, A5, A5R, A6, B5, Custom size: 98.0 x 190.5 mm to 216.0 x 355.6 mm Envelopes: COM10 No.10, Monarch, DL, ISO-C5	<b>Acceptable originals and weights</b>	Platen: Sheet, Book, and 3-Dimensional Objects Document Feeder media weight : 1-sided scanning: 42 to 128 gsm (BW), 64 to 128 gsm (CL) 2-sided scanning: 50 to 128 gsm (BW), 64 to 128 gsm (CL) Note: Business card: 80 to 220 gsm Original width narrower than A6 except business card: 50 to 128 gsm
<b>Supported media weights</b>	Multi-purpose tray: 60 to 220 gsm Cassette: 60 to 163 gsm Duplex: 60 to 163 gsm	<b>Supported media sizes</b>	Platen scanning size: up to 216.0 x 355.6 mm Document Feeder media size: A4, A5R, A6, B5, Custom size: 48.0 x 128.0 mm to 216.0 x 355.6 mm Business card: 48.0 x 85.0 mm to 55.0 x 91.0 mm
<b>Warm-up Time</b>	Quick Startup Mode: 4 seconds or less* (applicable to C359i/C259i) * Time from device power-on to when the copy icon appears and is enabled to operate on the touch panel display. From Sleep Mode: 10 seconds or Less From Power On: 10 seconds or Less* * iR-ADV DX C359i/C259i: Time from device power-on, until copy ready (not print reservation) * iR-ADV DX C359P: Time from device power-on, until print ready (not print reservation)	<b>Scan Speed (ipm: BW/CL, A4)</b>	<b>Copy:</b> Scan Speed priority (300 x 600 dpi): 1-sided Scanning: 50 2-sided Scanning: 100 Image Quality priority (600 x 600 dpi): 1-sided Scanning: 30 2-sided Scanning: 50
<b>Dimensions (W x D x H)</b>	iR-ADV DX C359i/C259i: 519 x 658 x 638 mm iR-ADV DX C359P: 519 x 658 x 525 mm	<b>Scan Resolution (dpi)</b>	Scan for Copy: up to 600 x 600 Scan for Send: (Push) up to 600 x 600 (SMB/FTP/WebDAV/IFAX), (Pull) up to 600 x 600 Scan for Fax: up to 600 x 600
<b>Installation Space(W x D)</b>	Basic: 852 x 908 mm (with Multi-purpose tray extended + paper cassette open) Fully Configured: 1,407 x 908 mm (with Staple Finisher-Z1 + Multi-purpose tray extended + paper cassette open)	<b>Pull Scan Specifications</b>	Colour Network ScanGear2. For both TWAIN and WIA Supported OS: Windows® 7/ 8.1/ 10/ Server2008/ Server2008 R2/ Server2012/ Server2012 R2/ Server 2016 As of Feb. 2020
<b>Weight</b>	iR-ADV DX C359i/C259i: Approx. 48 kg (including toner) iR-ADV DX C359P: Approx. 41 kg (including toner)	<b>Scan Method</b>	Push Scan, Pull Scan, Scan to Box, Scan to Advanced Space, Scan to Network, Scan to USB Memory Key, Scan to Mobile devices, Scan to cloud (uniFLOW Online - Optional)
<b>PRINT SPECIFICATIONS</b>		<b>SEND SPECIFICATIONS</b>	
<b>Print Speed*</b>	iR-ADV DX C359i/C359P 35 ppm (A4), 26 ppm (A5R), 61 ppm (A5), 23 ppm (A6) iR-ADV DX C259i 25 ppm (A4), 26 ppm (A5R), 46 ppm (A5), 23 ppm (A6) *1-sided	<b>Destination</b>	Standard: E-mail/Internet FAX (SMTP), SMB 3.1.1, FTP, WebDAV, Mail Box Optional: Super G3 FAX, IP Fax (for iR-ADV DX C359i/C259i)
<b>Duplex Print Speed (A4/LTR)</b>	iR-ADV DX C359i/C359P: BW 35ipm/36ipm, CL 35ipm/36ipm C259i: BW 25ipm/26ipm, CL 25ipm/26ipm	<b>Address Book</b>	LDAP (2,000)/Local (1,600)/Speed dial (200)
<b>Print Resolution (dpi)</b>	600 x 600 to 1,200 x 1,200 (equivalent)	<b>Send resolution (dpi)</b>	Push: up to 600 x 600 Pull: up to 600 x 600
<b>Page description languages</b>	Standard: UFR II, PCL6, Adobe® PostScript® 3™	<b>Communication protocol</b>	File: FTP(TCP/IP), SMB 3.1.1 (TCP/IP), WebDAV E-mail/I-Fax: SMTP, POP3
<b>Direct Print</b>	Supported file types: TIFF, JPEG, PDF, EPS, and XPS	<b>File Format</b>	Standard: TIFF, JPEG, PDF (Compact, Searchable, Apply policy, Optimize for Web, PDF A/1-b, Trace & Smooth, Encrypted, Device Signature, User Signature), XPS (Compact, Searchable, Device Signature, User Signature), Office Open XML (PowerPoint, Word)
<b>Printing from mobile and cloud</b>	AirPrint, Mopria, Universal Print by Microsoft, Canon PRINT Business, and uniFLOW Online A range of software and MEAP-based solutions are available to provide printing from mobile devices or internet-connected devices and cloud-based services depending on your requirements. Please contact your sales representative for further information	<b>Universal Send Features</b>	Original Type Selection, Two-sided Original, Density Adjustment, Sharpness, Erase Frame, Job Build, Delayed Send, Preview, Job Done Notice, File Name, Subject/Message, Reply-to, E-mail Priority, TX Report, Original Content Orientation, Skip Blank Pages
<b>Fonts</b>	PS fonts: 136 Roman PCL fonts: 93 Roman, 10 Bitmap fonts, 2 OCR fonts, Andalé Mono WT J/K/S/T <sup>†</sup> (Japanese, Korean, Simplified and Traditional Chinese), Barcode fonts <sup>†</sup> * Optional PCL International Font Set-A1 is required. ** Optional Barcode Printing Kit-D1 is required.		
<b>Print Features</b>	Secured Print, Secure Watermark, Header/Footer, Page Layout, Two-sided Printing, Toner Reduction, Poster Printing, Forced Hold printing, Print Date, Scheduled Printing, Printing Using a Virtual Printer		

# TECHNICAL SPECIFICATIONS

# imageRUNNER ADVANCE DX C259/C359 Series

## FAX SPECIFICATIONS

Maximum Number of Connection Lines	(Optional) 2 (2nd Line optional)
Modem Speed	Super G3: 33.6 kbps G3: 14.4 kbps
Compression Method	MH, MR, MMR, JBIG
Resolution (dpi)	400x400 (Ultra Fine), 200x400 (Super Fine), 200x200 (Fine), 200x100 (Normal)
Sending/Recording Size	A4, A5*, A6*, B5*/A4, A5, B5 *Sent as A4
FAX memory	Up to 30,000 pages (2,000 jobs)
Speed dials	Max. 200
Group dials/destinations	Max. 199 dials
Sequential broadcast	Max. 256 addresses
Memory backup	Yes
Fax Features	Sender's Name (TTI), Selecting the Telephone Line (when sending fax), Direct Send, Delayed Send, Preview, Job Done Notice, TX Report, Interrupt Transmission, Sequential Broadcasting, Password/Subaddress Sending, Confidential Mailbox, 2 on 1 Log

## STORE SPECIFICATIONS

Mail Box (Number supported)	100 User Inboxes, 1 Memory RX Inbox, 50 Confidential Fax Inboxes Maximum 10,000 Pages (2,000 jobs) Stored
Advanced Space	Communication Protocol: SMB or WebDAV Supported Client PC: Windows* 8.1/10 Concurrent Connections (Max.): SMB:64, WebDAV:3
Advanced Space available disc space	Approx. 16GB
Advanced Space Features	Authentication for Advanced Space Log-in, Sort Function, Printing a PDF File with a Password, imageWARE Secure Audit Manager Support, Search, File Preview, Authentication Management, Open to public, URI TX, Backup/Restore

## SECURITY SPECIFICATIONS

Authentication and Access Control	User Authentication (Picture Login, Picture and PIN Login, Card Login, Username and Password Login, Function Level Login, Mobile Login), Department ID Authentication (Department ID and PIN Login, Function Level Login), uniFLOW Online Express (PIN Login, Picture Login, Picture and PIN Login, Card Login, Card and PIN Login, Username and Password Login, Department ID and PIN Login, Function Level Login), Access Management System (Access Control)
Document Security	Print Security (Secure Print, Encrypted Secure Print, Forced Hold Printing, uniFLOW Secure Print**), Receive Data Security (Confidential Fax Inbox Forwarding Received Documents Automatically), Scan Security (Encrypted PDF, Device Signature PDF/XPS, User Signature PDF/XPS, Adobe LiveCycle® Rights Management ES2.5 Integration), BOX Security (Mail Box Password Protected, Advanced Space Access Control), Send Data Security (Setting for requesting password input per transmission, Restricted E-mail/File send functions, Confirming FAX number, Allow/Restrict Fax Driver Transmissions, Allow/Restrict Sending from History, S/MIME Support), Document Tracking (Secure Watermark) ** Requires uniFLOW Online / uniFLOW
Network Security	TLS 1.3, FTPS, IPsec, IEEE802.1X authentication, WPA3 support (Wi-Fi), SNMP V3.0, Firewall Functionality k(IP/MAC Address Filtering), Dual Network Support (Wired LAN/Wireless LAN, Wired LAN/Wired LAN), Disabling Unused Functions (Enabling/Disabling Protocols/Applications, Enabling/Disabling Remote UI, Enabling/Disabling USB Interface), G3 FAX separation from LAN, USB Port separation from LAN, Prohibit the execution of files stored in Advanced Space in the MFP, Scan and Send -Virus Concerns for E-mail Reception
Device Security	Protecting SSD Data [SSD Data Encryption (FIPS 140-2/140-3*), SSD Lock], Standard SSD Initialize, Trusted Platform Module (TPM 2.0), Job Log Conceal Function, Protecting MFD Software Integrity, Checking MFD Software Integrity & Platform Firmware Resiliency (NIST SP800-193) with Automatic System Recovery (Verify System at Startup, Runtime Intrusion Detection), Comply IEEE2600.2 (Common Criteria Certification) *validation pending
Device Management and Auditing	Administrator Password, Digital Certificate And Key Management, Remote Management Two-factor Authentication, Audit Log, Cooperating with External Security Audit System (Security Information and Event Management), Image Data Logging, Security Policy Setting Device administration and Security administration Passwords

## ENVIRONMENTAL SPECIFICATIONS

Operating Environment	Temperature: 10 to 30 °C Humidity: 20 to 80 % RH (Relative Humidity)
Power source	220-240 V, 50/60 Hz, 3.9 A
Power consumption	Maximum: Approx. 1,500 W Copying (iR-ADV DX C359i/C259i with DADF continuous scan): 575.4 W* <sup>1</sup> Printing (iR-ADV DX C359P) [LAN Print (color mode, duplex, with Cassette Feeding unit-AK1)]: 488.5 W* <sup>1</sup> Standby: Approx. 40.3 W* <sup>1</sup> Sleep mode: Approx. 0.8 W* <sup>2</sup> * <sup>1</sup> Reference value: measured one unit * <sup>2</sup> 0.8 W sleep mode is not available in all circumstances due to certain settings.
Noise levels	Typical Electricity Consumption (TEC)*: iR-ADV DX C359i/C359P: 0.33kWh iR-ADV C259i: 0.22kWh *As per USA Energy Star 3.0
Standards	For detailed information relating to Erp:Lot6/26 regulation, please go to: <a href="https://www.canon-europe.com/for_work/lot26/">https://www.canon-europe.com/for_work/lot26/</a> <b>Sound Power Level (LWA, m)*</b> Active (BW) (1-sided): iR-ADV DX C359i/C359P: 65 dB, Kv 3 dB iR-ADV DX C259i: 62 dB, Kv 3 dB * Reference value: measured only one unit with ISO7779, described with ISO9296 (2017) <b>Sound Pressure (LpAm)</b> Bystander's position: Active (BW) (1-sided): iR-ADV DX C359i/C359P: 52 dB* iR-ADV DX C259i: 49 dB* Standby: iR-ADV DX C359i/C359P/C259i: 8 dB * Reference value: measured only one unit with ISO7779, described with ISO9296 (2017) Blue Angel

## CONSUMABLES

Toner Cartridges	C-EXV 55 Toner BK/C/M/Y
Toner (Estimated Yield @ 5% Coverage)	C-EXV 55 TONER BK: 23,000 pages C-EXV 55 TONER C/M/Y: 18,000 pages

## SOFTWARE AND PRINTER MANAGEMENT

Tracking and reporting	For detailed information please visit our website <a href="https://www.canon-europe.com/business/">https://www.canon-europe.com/business/</a> Universal Login Manager (ULM) uniFLOW Online Express* * For more information, please refer to <a href="#">uniFLOW Online Express</a> <a href="#">uniFLOW Online</a>
Remote management tools	iW Management Console eMaintenance Content Delivery System
Scanning software	Network ScanGear
Platform	MEAP (Multifunctional Embedded Application Platform)
Document Publishing	Kofax PowerPDF (optional)
PAPER SUPPLY OPTIONS	
Cassette Module-AE1	Paper Capacity: 550 sheets (80 gsm) Paper Type: Thin, Plain, Heavy, Recycled, Color, Pre-punched, Bond Paper Size: A4, A5R, B5, Custom size: 98.0 x 190.5 mm to 216.0 x 355.6 mm Paper Weight: 60 to 163 gsm Power Source: From the Main Unit Dimensions (W x D x H): 511 x 508 x 159 mm (attached to the main unit) Weight: Approx. 10 kg
Cassette Feeding Unit-AJ1	Paper Capacity: 550 sheets (80 gsm) Paper Type: Thin, Plain, Recycled, Heavy, Color, Pre-punched, Bond Paper Size: A4, A5R, B5 Custom size: 98.0 x 190.5 mm to 216.0 x 355.6 mm Paper Weight: 60 to 163 gsm Power Source: From the Main Unit Dimensions (W x D x H): 511 x 508 x 425 mm (attached to the main unit) Weight: Approx. 16 kg
Cassette Feeding Unit-AK1	Paper Capacity: 550 sheets (80 gsm) x 3 cassettes Paper Type: Thin, Plain, Recycled, Heavy, Color, Pre-punched, Bond Paper Size: A4, A5R, B5 Custom size: 98.0 x 190.5 mm to 216.0 x 355.6 mm Paper Weight: 60 to 163 gsm Power Source: From the Main Unit Dimensions (W x D x H): 511 x 508 x 425 mm (attached to the main unit) Weight: Approx. 19 kg

# TECHNICAL SPECIFICATIONS

# imageRUNNER ADVANCE DX C259/C359 Series

## OUTPUT OPTIONS\*

### Staple Finisher-Z1

\*Paper capacity may vary with different paper type/size.  
Tray Capacity (80 gsm):  
A4, A5, A5R, A6, B5: 500 sheets  
Paper Weight: 60 to 220 gsm  
Staple Position: Corner  
Staple Capacity:  
A4, B5: 30 sheets (60 to 105 gsm)  
Power Source: From the Main Unit  
Dimensions (W x D x H): 555 x 459 x 301 mm (Unit size)  
Weight: Approx. 14 kg

## HARDWARE ACCESSORIES

### Card Readers

Various card readers available e.g. MiCard Plus. Please contact local Canon Office for more details.  
Copy Card Reader-F1  
Copy Card Reader Attachment-B5

## SYSTEM AND CONTROLLER OPTIONS

### Print Accessories

PCL International Font Set-A1

### Barcode Printing

Barcode Printing Kit-D1

### System Accessories

Copy Control Interface Kit-A1  
Wireless LAN Board-D1  
Serial Interface Kit-K3

### FAX Accessories

Super G3 FAX Board-BL1  
Remote Fax Kit-A1  
IP FAX Expansion Kit-B1

## OTHER OPTIONS

### Accessibility Accessories

ADF Access Handle-A1

### Consumables

Staple-P1

## Software & Solutions



## Certifications and compatibility



**Canon Ireland**  
3006 Lake Drive  
Citywest, Saggart  
Co. Dublin, Ireland  
Telephone No: 01 2052400  
Facsimile No: 01 2052525  
canon.ie

**Canon (UK) Ltd**  
The Bower  
4 Roundwood Avenue  
Stockley Park  
Uxbridge  
UB11 1AF

**Canon Electronics Inc.**  
canon-elec.co.jp  
**Canon Europe**  
canon-europe.com  
English edition  
© Canon Europa N.V., 2023